

ROTARY CUTTER (HEAVY DUTY)
 MODEL TC16-500MC
 MODEL TC16-600MC
 MODEL TC16-700MC

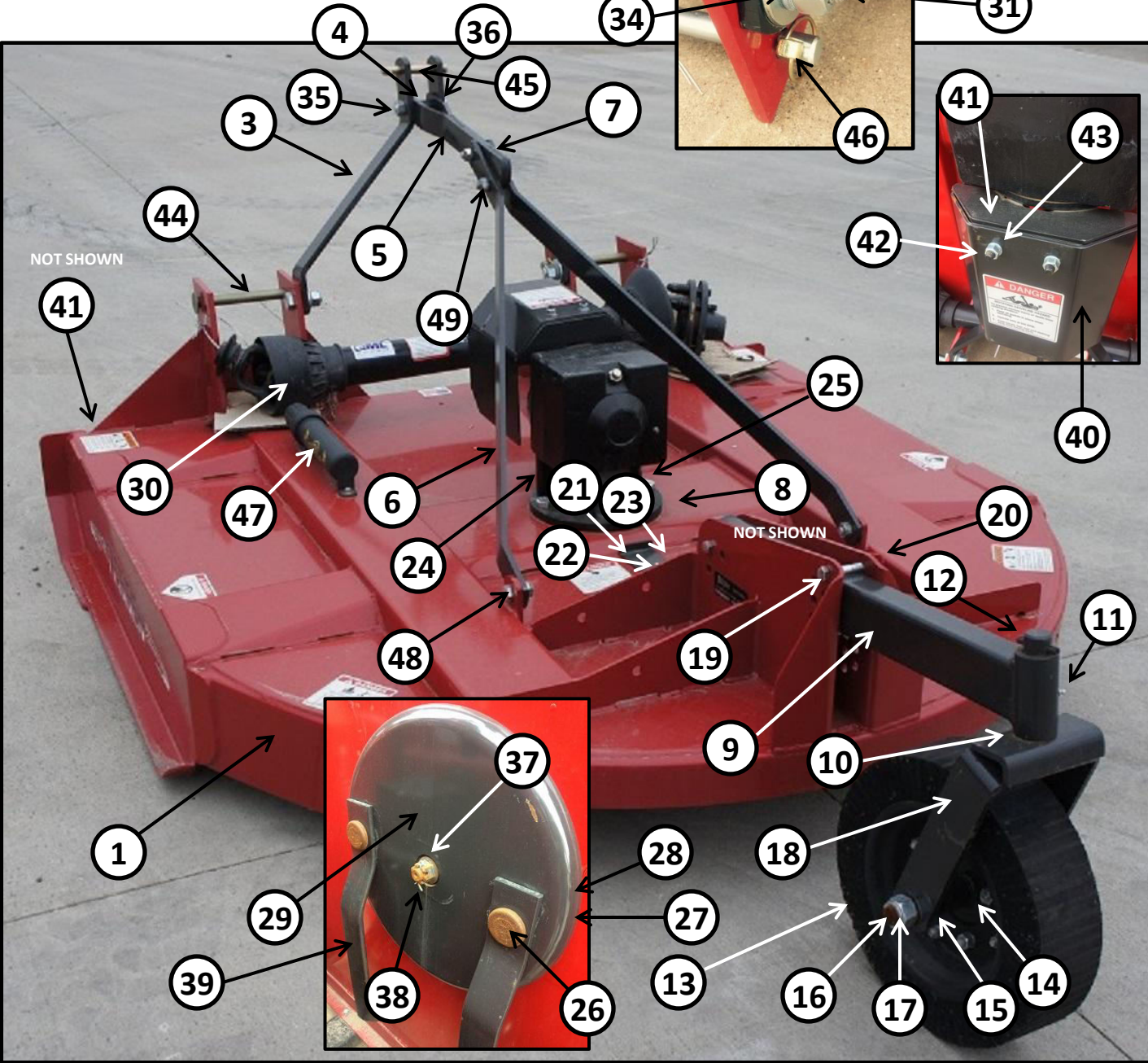

**** SEE PAGES 33 & 33-1 FOR CHAIN GUARD INFORMATION REGARDING MODEL TC16-500MC & MODEL TC16-600MC.**

ROTARY CUTTER (HEAVY DUTY)**PARTS LIST****MODEL TC16-500MC****MODEL TC16-600MC****MODEL TC16-700MC**

<u>REF. NO.</u>	<u>PART NO.</u>	<u>DESCRIPTION</u>	<u>QTY</u>
1	64-5008	DECK, 60"	1
	64-6008	DECK, 72"	1
	64-7008	DECK, 84"	1
2	60-852	BUSHING, UPRIGHT	2
3	60-820	UPRIGHT	2
4	60-851L	2-1/4" BUSHING, LARGE	1
5	64-80012W	LINKAGE ARM	1
6	60-800	ATTACHING BRACE	2
7	60-908	5/8-11X2-1/2 HX CAP 5NC ZC	2
8	61-625	3/4-10 HX NUT, NYLOC ZC	4
9	60-725	REAR ARM WELDMENT	1
10	60-740	NR BUSHING WASHER, 1-1/4	1
11	60-741	GREASE FITTING, DRIVE IN	1
12	60-742	EXPAND PIN, 3/16X2-1/4	1
13	60-746L	RIM & TIRE, LAMINATED	1
14	60-746H	HUB, STEEL W/ BUSHINGS	1
15	60-747	WHEEL SPACER	2
16	60-748	AXLE BOLT, 1-8X8-1/2 HX CAP ZC	1
17	60-749	1-8 HX NUT NYLOC ZC	1
18	60-700	WHEEL FORK	1
19	60-902	1/2-13X3 HX CAP 5NC ZC	3
20	60-903	1/2-13 HX NUT, CENTERLOCK ZC	3
21	60-875	ACCESS COVER	1
22	60-904	5/16-18 HX NUT, CENTERLOCK	1
23	60-905	5/16 FLATWASHER	1
24	60-975	GEARBOX - 60" & 72" DECK	1
		GEARBOX - 84" DECK	1
25	60-934	3/4-10X2-1/2 HX CAP 5NC ZC	4
26	60-910	BLADE MOUNTING BOLT	2
27	60-912	BLADE BOLT JAM NUT, 1-1/8	2
28	60-913	LOCK WASHER, 1-1/8	2
29	60-755	STUMP JUMPER PAN	1
30	60-976	DRIVELINE, 60" & 72" CUTTER	1
	60-986	DRIVELINE, 84" CUTTER	1
31	60-907	7/8-9X2-1/2 HX CAP 5NC ZC	2
32	60-923	7/8-9 HX NUT ZC	2
33	60-921	7/8 FLATWASHER	2
34	60-922	7/8 LOCKWASHER	2
35	60-924	3/4-10X4 HX CAP 5NC ZC	1
36	60-925	3/4-10 HX NUT, CENTERLOCK	1

ROTARY CUTTER (HEAVY DUTY)**PARTS LIST****MODEL TC16-500MC****MODEL TC16-600MC****MODEL TC16-700MC**

<u>REF. NO.</u>	<u>PART NO.</u>	<u>DESCRIPTION</u>	<u>QTY</u>
37	64-661	SLOTTED FLANGE NUT	1
38	64-662	COTTER PIN	1
39	60-915	BLADE - 60" CUTTER	2
	60-916	BLADE - 72" CUTTER	2
	60-987	BLADE - 84" CUTTER	2
40	60-8450	SHIELD	1
41	60-846	SHIELD BRACKET	1
42	60-926	3/8-16 HX NUT ZC	2
43	60-927	3/8 LOCKWASHER	2
44	60-991	LOWER 3 PT PIN	2
45	60-870	UPPPER 3 PT PIN	1
46	60-871	LYNCH PIN	3
47	64-1010	MANUAL CONTAINER	1
48	60-898	5/8-11X1-1/2 HX CAP 5NC ZC	2
49	60-838	5/8-11 HX NUT, CENTERLOCK ZC	4
		REF. NO'S BELOW ARE NOT SHOWN ON BREAKDOWN	
50	60-887	FRONT CHAIN GUARD DEFLECTOR	1
51	60-869	CHAIN, 7 LINKS	VAR.
52	64-80084	REAR CHAIN GUARD DELFECTOR	1